

WVL-02, 02CN Type Level Control Valve (for Water)



Large capacity level control valve for water receiving tank of water supply pipeline, water receiving tank of farm-land irrigation pipeline, and pressure reducing tank etc.

■ SPECIFICATIONS

Type	Standard		Nylon coating
Model name	WVL-02		WVL-02CN
Code name	WVL02-B	WVL02-L	WVL02CN-B
Size	80-400(3"-16")	80-200(3"-8")	80-200(3"-8")
Applicable fluid	Water		
Fluid temperature	5-60°C		
Applicable pressure	Size 80-200mm:0.03-0.75MPa, Size 250-400mm:0.05-0.75MPa		
Min. press differential across the disc	Size 80-200mm:0.03MPa, Size 250-400mm:0.05MPa		
End connection	Flanged JIS 10KRF		
Materials	Body	Cast iron	Ductile cast iron
	Trim	Diaphragm & disc(Synthetic rubber), Seat ring(Cast bronze)	
Painting or coating for Body	Interior:Epoxy resin		Nylon 11 coating
Valve body pressure test	Hydraulic 1.75MPa		
Installation	Vertically in horizontal pipe line.		
Accessories ball tap	Body Size 80-200mm:Size 20mm(Polyethylene ball) Body Size 250-400mm:Size 25mm(Polyethylene ball)		

* Refer to Page 101 for valve size selecting chart.

■ DIMENSIONS (Body: Cast iron)

(mm)

Size	L	G	H	H ₁	E	E ₁	Cv value	Mass(kg)
80(3")	350	110	277	261	117	—	90	43
100(4")	400	130	303	300	130	—	160	60
125(5")	440	140	334	371	145	—	250	70
150(6")	500	165	367	416	173	—	360	125
200(8")	600	200	418	522	218	—	640	200
250(10")	720	240	490	560	295	390	1000	470
300(12")	820	280	540	620	328	400	1440	524
400(16")	1040	370	690	800	440	490	2560	1400

* Please contact our local agent for the dimensions of the main valve whose body is made of ductile cast iron.

Flanged code JIS 10KRF

■ CONSTRUCTION

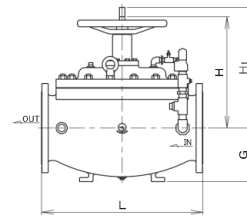
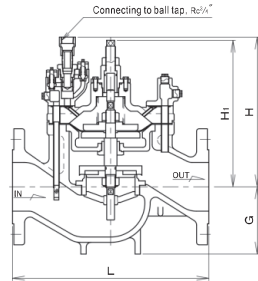
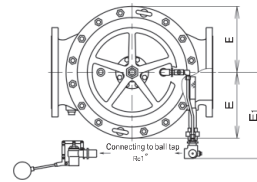
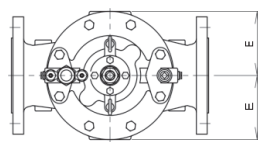

Size 80-200mm

Size 250-400mm